

## ZIGZAG SEWING MACHINE NZ-120

# PARTS LIST

---

### I N D E X

1	ARM SHAFT SECTION I .....	2
2	ARM SHAFT SECTION II .....	4
3	LOWER SHAFT SECTION .....	6
4	COVER SECTION I .....	8
5	COVER SECTION II .....	10
6	ELECTRIC SECTION .....	12
7	ACCESSORY SECTION .....	14

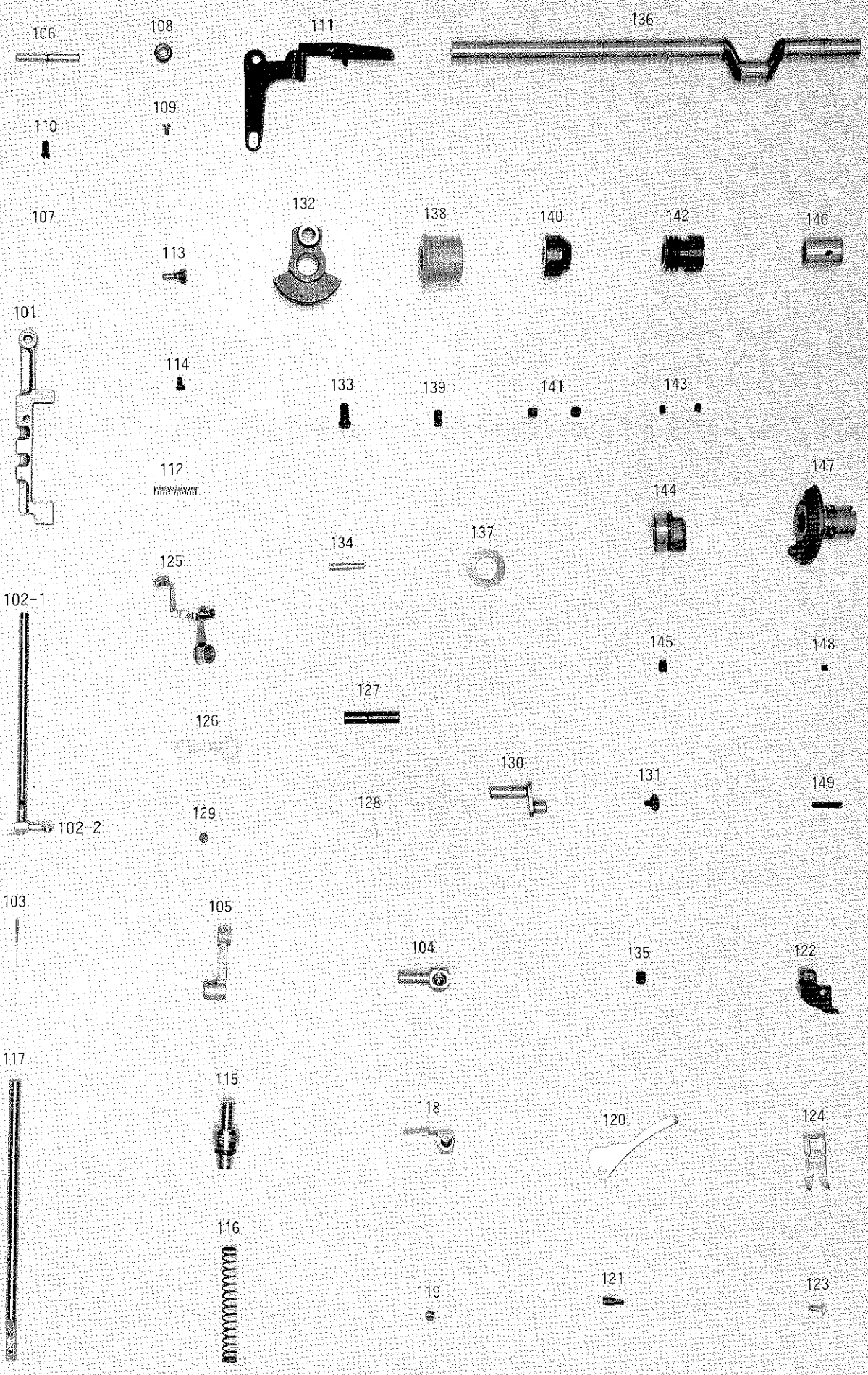

# 1. ARM SHAFT SECTION I

Ref. No.	Part No.	Description	Amt Req.	Price	Note
101	020745004-000	Needle bar driving frame	1		
102-1	020947000-000	Needle bar	1		
102-2	020801001-000	Needle clamp	1		
103	000286227-000	Needle	1		
104	020984007-000	Needle bar bracket	1		
105	020983003-000	Needle bar connecting rink	1		
106	020354009-000	Needle bar driving frame pin	1		
107	170104005-024	Snap ring for 106	1		
108	073169007-000	Collar for 106	1		
109	320130052-034	Set screw for 108	1		
110	124014008-024	Set screw for 106	1		
111	020907001-000	Needle bar connecting plate	1		
112	020815000-000	Zigzag driving crank spring	1		
113	020786006-000	Adjusting screw for 101	1		
114	123060009-024	Set screw for 113	1		
115	020435002-000	Pressure regulator	1		
116	020317001-000	Presser bar spring	1		
117	020750001-000	Presser bar	1		
118	020570001-000	Presser bar spring bracket	1		
119	116001001-024	Set screw for 118	1		
120	020877004-000	Presser foot lifter	1		
121	020035006-000	Presser foot lifter hinge stud	1		
122	000421358-000	Presser foot holder	1		
123	123010006-074	Set screw for 122	1		
124	000421292-000	Presser foot(Zigzag)	1		
125	020964008-000	Take-up lever	1		
126	020675011-000	Take-up lever holdor	1		
127	020676002-000	Take-up lever holdor hinge stud	1		
128	170106002-024	Snap ring for 127	1		
129	116002004-024	Set screw for 127	1		
130	020965001-000	Take-up lever crank	1		
131	123041003-024	Set screw for 130	1		
132	020874003-000	Arm shaft crank	1		
133	126011001-024	Set screw for 132	1		
134	020888002-000	Taper pin for 132	1		
135	117002001-024	Set screw for 132	1		
136	020814018-000	Arm shaft	1		
137	160153010-000	Thrust washer t=0.5	1		
138	020553003-000	Arm shaft front bushing	1		
139	116005005-024	Set screw for 138	1		
140	020507005-000	Arm shaft collar	1		
141	117004009-024	Set screw for 140	2		
142	072524000-000	Worm gear	1		
143	114002000-024	Set screw for 142	2		
144	020755009-000	Feed cam	1		
145	116001001-024	Set screw for 144	1		
146	020349002-000	Arm shaft back bushing	1		
147	020353005-000	Hand wheel bushing	1		
148	114001006-024	Set screw for 147	1		
149	170409001-024	Spring pin for 147	1		

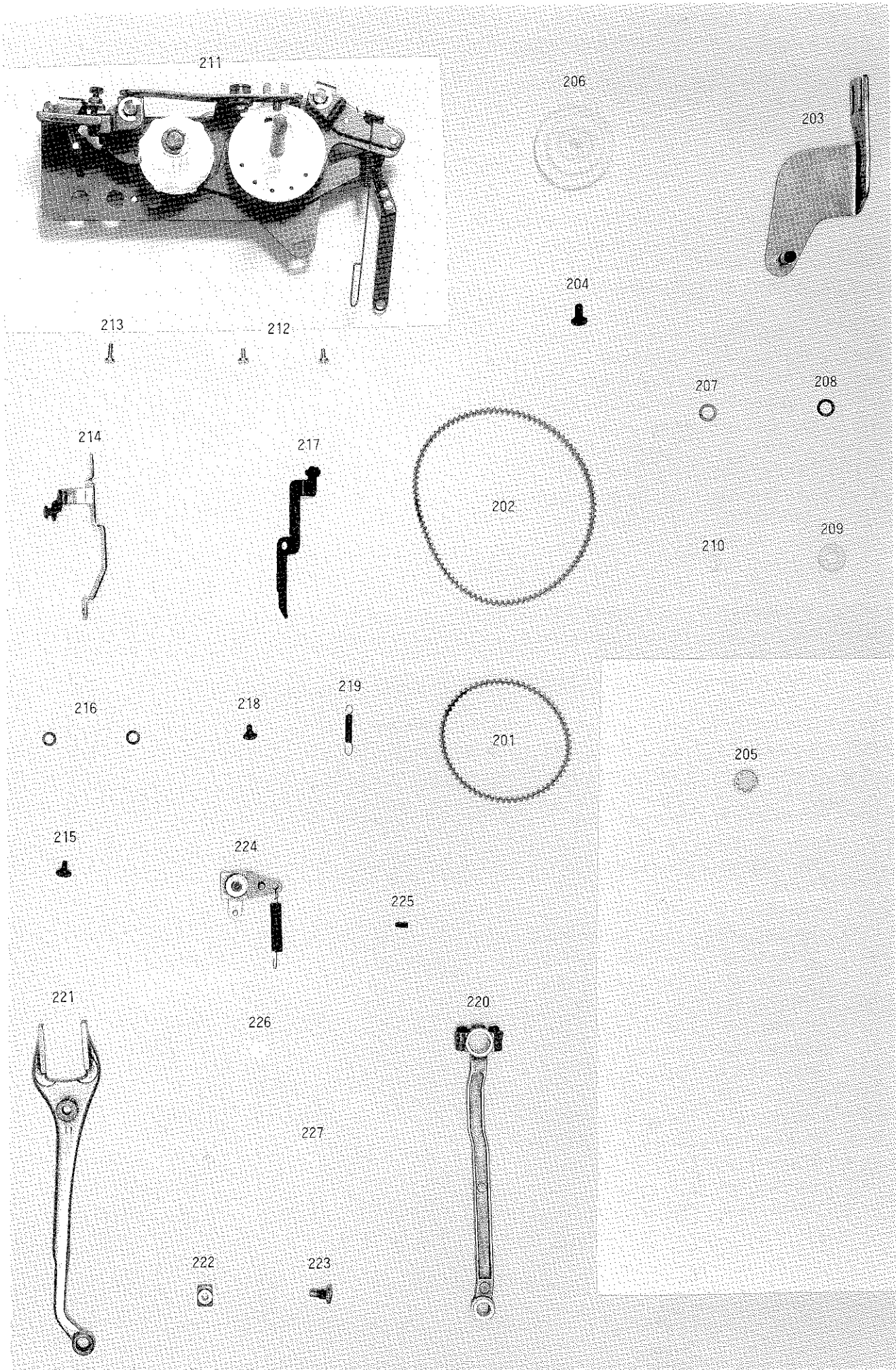

2. ARM SHAFT SECTION II

Ref. No.	Part No.	Description	Amt Req.	Price	Note
201	170922503-000	W-belt 250	1		
202	170923702-000	W-belt 370	1		
203	020905004-000	Pulley bracket	1		
204	365000040-024	Set screw for 203	1		
205	170806018-034	Inside toothed wsher for 203	1		
206	020899001-000	Pulley	1		
207	171312008-000	Thrust washer for pulley(7×0.25)	1		
208	171304001-000	Thrust washer for pulley(7×0.5)	1		
209	171906014-074	Washer for 206	1		
210	170105009-024	Snap ring for 206	1		
211	073063018-000	Unit frame assembly	1		
212	320235073-024	Set screw for 211	2		
213	320235103-024	Set screw for 211	1		
214	073082001-000	Zigzag lever	1		
215	353500044-024	Set screw for 214	1		
216	160044008-044	Wavy washer for 214	2		
217	051474003-000	Tention releasing plate A	1		
218	153009003-024	Set screw for 217	1		
219	030923002-000	Spring for 217	1		
220	020903007-000	Crank rod	1		
221	031090009-000	Forked rod	1		
222	030546006-000	Feed regulator slide block	1		
223	030545002-000	Stud for 222	1		
224	031065003-000	Feed regulator assembly	1		
225	310440083-024	Set screw for 224	1		
226	160140002-094	Washer for 224	1		
227	170103001-024	Snap ring for 224	1		

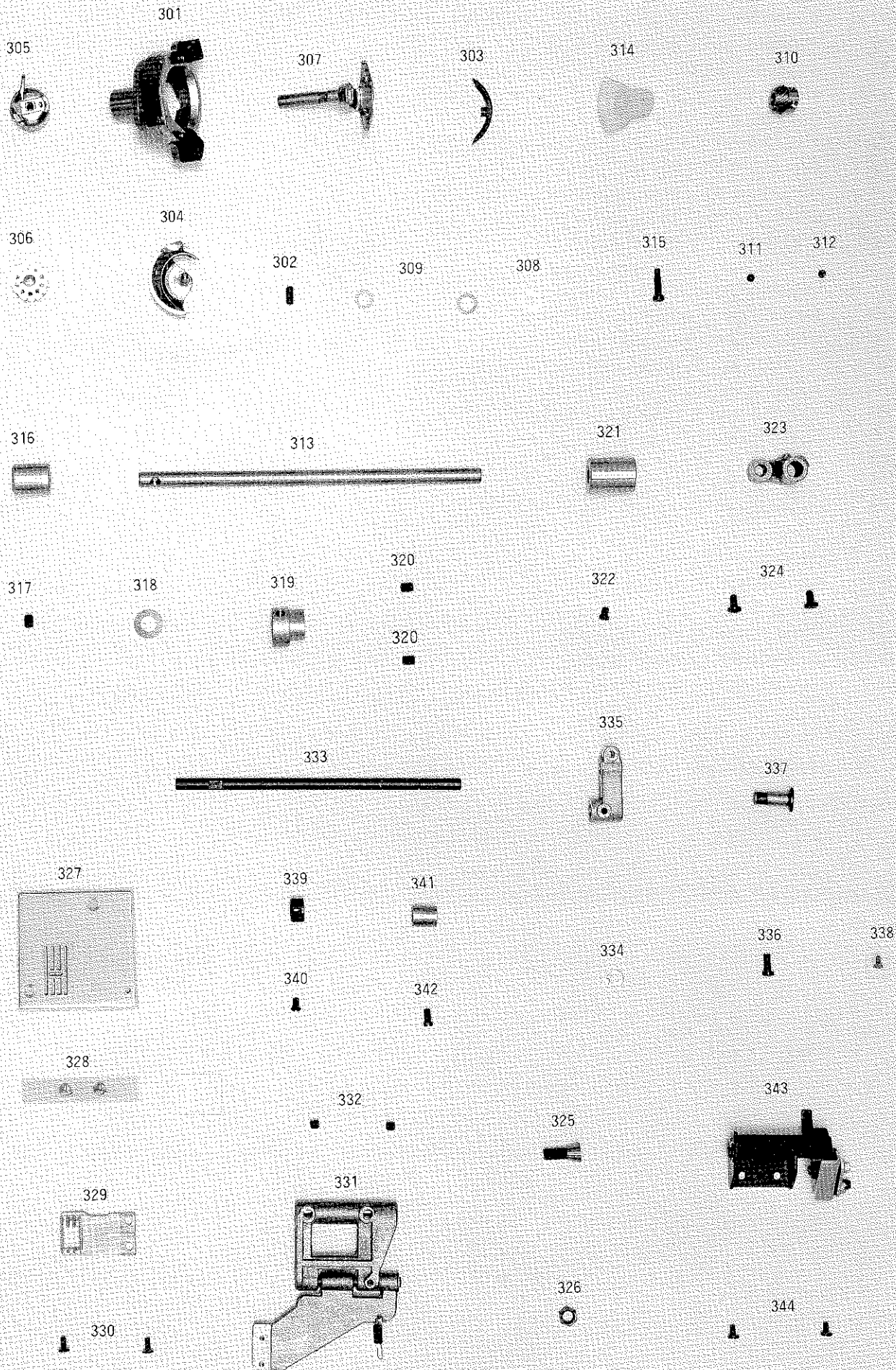

3. LOWER SHAFT SECTION					
Ref. No.	Part No.	Description	Amt Req.	Price	Note
301	040826001-000	Shuttle race	1		
302	310350107-024	Set screw for 301	1		
303	040783008-000	Shuttle cleaner	1		
304	040377001-000	Shuttle hook	1		
305	040378017-000	Bobbin case	1		
306	000001005-000	Bobbin	1		
307	040858001-000	Shuttle driver assembly	1		
308	160159000-000	Thrust washer for 307(SUS)	1		
309	171308005-000	Thrust washer for 307(8×0.5)	2		
310	040835001-000	Shuttle driver shaft bevel gear	1		
311	114008001-024	Set screw for 310	1		
312	114024006-024	Set screw for 310	1		
313	040996001-000	Lower shaft	1		
314	040862004-000	Lower shaft gear	1		
315	124041001-024	Set screw for 314	1		
316	040516009-000	Lower shaft front bushing	1		
317	116002004-024	Set screw for 316	1		
318	160127009-000	Washer for 316	1		
319	040660009-000	Lower shaft cam	1		
320	116002004-024	Set screw for 319	2		
321	040854007-000	Lower shaft back bushing	1		
322	124012001-024	Set screw for 321	1		
323	040954006-000	Lower shaft crank	1		
324	124049000-024	Set screw for 323	2		
325	040604006-000	Crank rod hinge screw	1		
326	040605000-000	Nut for 325	1		
327	040269388-084	Needle plate	1		
328	134002002-014	Set screw for 327	2		
329	041032017-000	Feed dog	1		
330	123004006-024	Set screw for 329	2		
331	040908033-000	Feed rock assembly	1		
332	116001001-024	Set screw for 331	2		
333	040997005-000	Feed rock shaft	1		
334	170105009-024	Snap ring for 333	1		
335	040837009-000	Feed rock shaft crank	1		
336	124003000-024	Set screw for 335	1		
337	040724004-000	Forked rod hinge screw	1		
338	310440060-024	Set screw for 337	1		
339	020409003-000	Collar for 338	1		
340	124012001-024	Set screw for 339	1		
341	040558004-000	Bushing for 333	1		
342	124014008-024	Set screw for 341	1		
343	040904003-000	Drop feed assembly	1		
344	320235061-024	Set screw for 343	2		

401

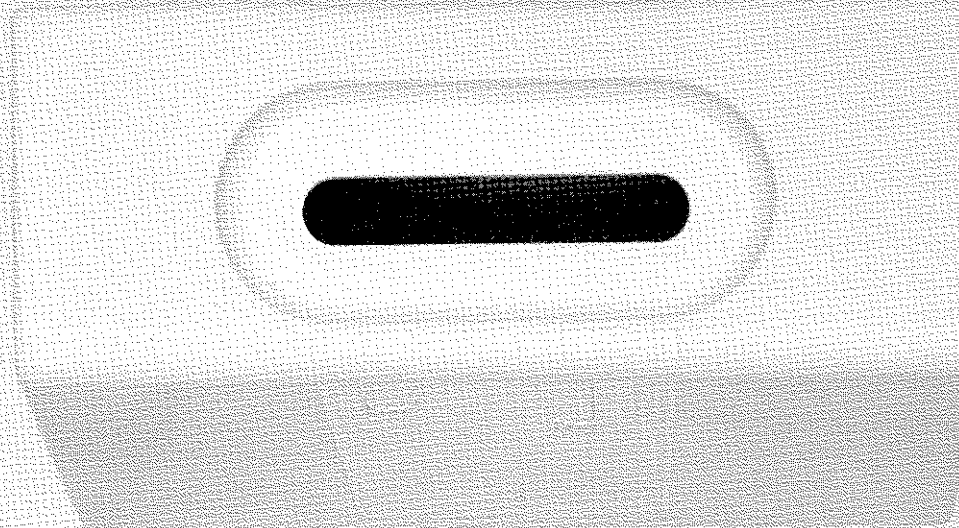

402

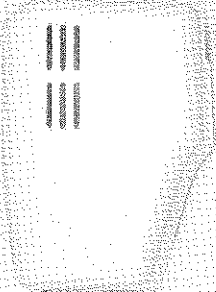

406

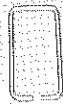

406

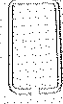

405



407



407



409



403



408



408



415

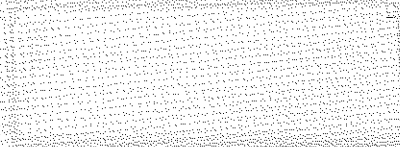

404



416

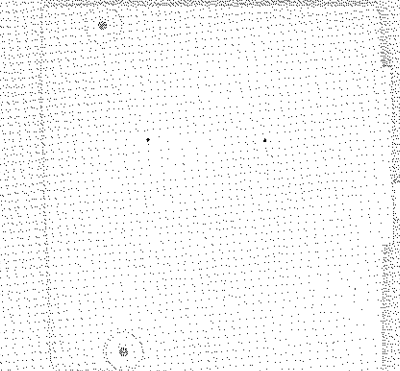

410

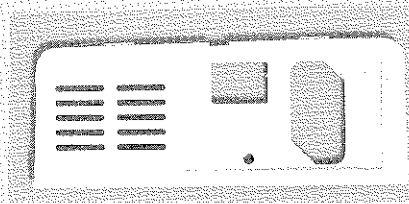

414



411



413



419



422



417

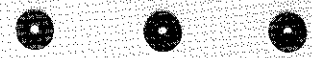

412



421



420



418





#### 4. COVER SECTION I

Ref. No.	Part No.	Description	Amt Req.	Price	Note
401	010823001-223	Machine cover	1		
402	010885005-223	Face plate	1		
403	320235061-074	Set screw for 402	1		
404	060480002-000	Reflecting plate for 402	1		
405	010650005-223	Handle	1		
406	010651009-000	Handle ring	2		
407	010652002-000	Handle ring holder	2		
408	320250086-034	Set screw for 407	2		
409	010882004-000	Vinyl sheet for 405	1		
410	010892060-223	Belt cover	1		
411	321030051-074	Set screw for 410	1		
412	010893002-223	Bottom cover for bed	1		
413	320235061-024	Set screw for 412	2		
414	010894006-223	Cap for shuttle driver axle hole	1		
415	010889000-223	Extention slide table	1		
416	010888006-223	Bottom cover	1		
417	010404009-000	Bottom bumper	3		
418	320235085-024	Set screw for 417	3		
419	010624006-000	Adjust screw	1		
420	010820000-000	Spring for 419	1		
421	160018009-034	Washer for 419	1		
422	010901003-000	Rubber sheet for 419	1		

504



503



501

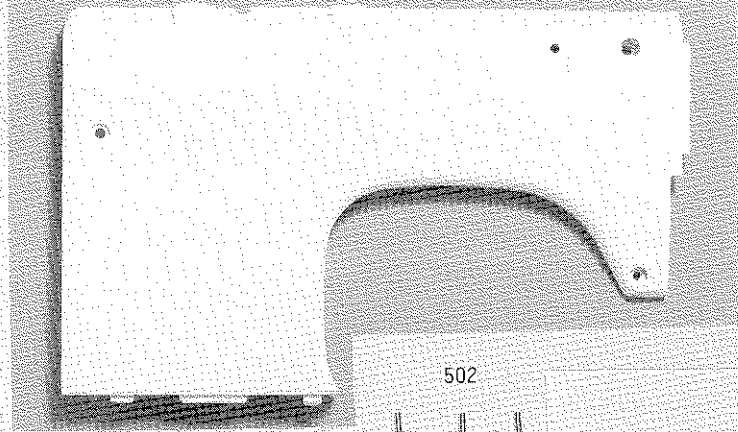

502

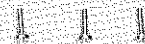

517

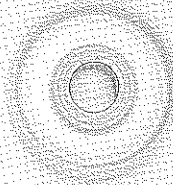

518



519



520



505



506



507

508



513

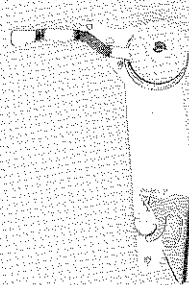

514



511



512



516



515



521



522

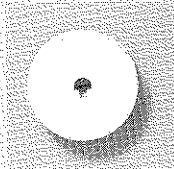

526



524

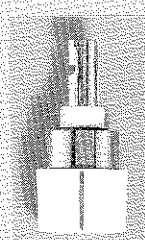

509

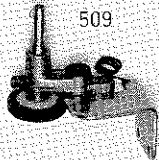

525



523



527



510



5. COVER SECTION II

Ref. No.	Part No.	Description	Amt Req.	Price	Note
501	010884001-223	Rear cover	1		
502	320235103-074	Set screw for 501	3		
503	050748004-000	Spool pin B	1		
504	051004005-000	Spring for 503	1		
505	051490008-000	Bobbin winder thead guide	1		
506	320235061-074	Set screw for 505	1		
507	171103502-034	Washer for 505	1		
508	341135300-024	Nat for 505	1		
509	051471002-000	Bobbin winder	1		
510	320235061-024	Set screw for 509	2		
511	050978006-000	Bobbin winder stop	1		
512	320235141-074	Set screw for 511	1		
513	051477004-075	Tention dial assembly	1		
514	051476001-000	Set screw for 513	1		
515	051689004-000	Set screw for 513	1		
516	051705002-000	Spring for 513	1		
517	051145006-223	Hand weel	1		
518	050959001-223	Stop motion screw	1		
519	050716003-000	Stop motion clamp screw	1		
520	050704001-000	Stop motion washer	1		
521	051645001-115	Stitch pattern indicator	1		
522	051482001-223	Stitch pattern dial	1		
523	051535008-223	Zigzag knob	1		
524	031070000-185	Stitch length knob	1		
525	126011001-024	Set screw for 524	1		
526	051500006-000	Arm thread guide	1		
527	124035012-034	Set screw for 526	1		

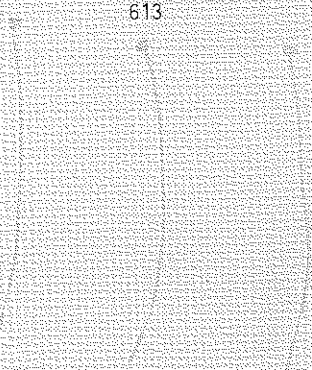
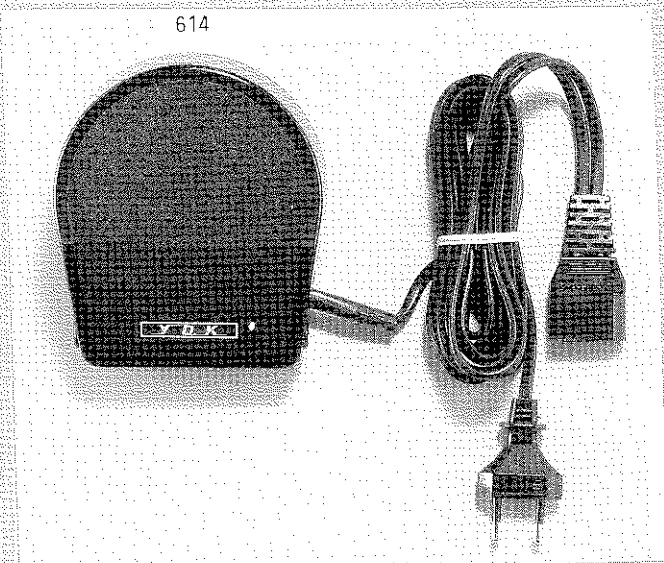
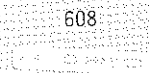
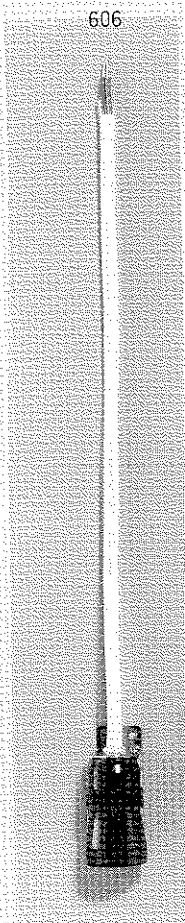
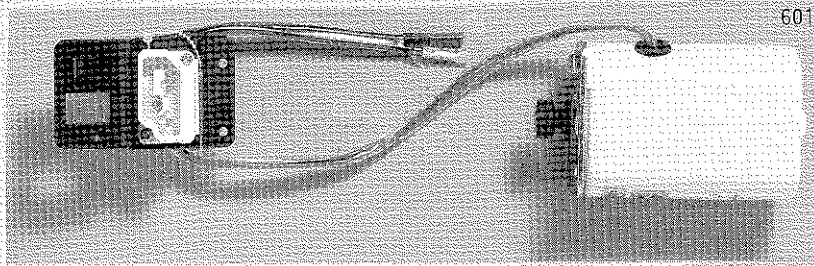

6. ELECTRIC SECTION					
Ref. No.	Part No.	Description	Amt Req.	Price	Note
601	060270515-000	Motor set	1		
602	370250120-024	Set screw for motor braket	1		
603	365000026-024	Set screw for motor braket	1		
604	320235061-024	Set screw for connector	1		
605	330135082-024	Set screw for connector	1		
606	060179222-000	Sew light assembly	1		
607	320230051-074	Set screw for 606	2		
608	060479001-000	Sew light holder	1		
609	320235061-024	Set screw for 608	1		
610	000249012-000	Blud	1		
611	060255011-000	Cord cover	1		
612	060483003-000	Cord clamp	1		
613	173200013-000	Cord fastener	3		
614	060288143-000	Foot controler	1		

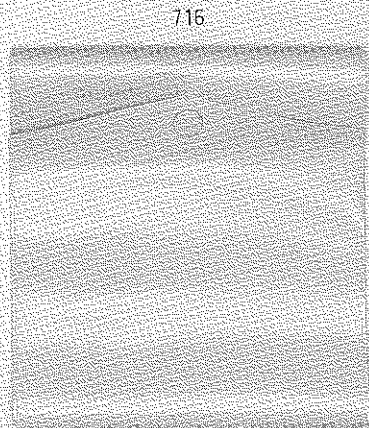
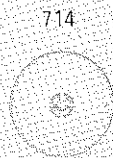
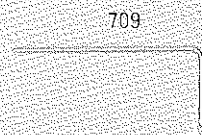

7. ACCESSORY SECTION

Ref. No.	Part No.	Description	Amt Req.	Price	Note
701	000979008-000	Screw driver(large)	1		
702	000253027-000	Screw driver(small)	1		
703	000252023-000	Oil	1		
704	000286197-000	Needle(#14×1、 #11×2)	1		
705	000001005-000	Bobbin	5		
706	000421371-000	Buttonhole foot	1		
707	000421311-000	Straight stitch foot	1		
708	000421061-000	Hemmer foot	1		
709	000421085-000	Quilter	1		
710	000421127-000	Overlock foot	1		
711	000421190-000	Blind stitch foot	1		
712	000421218-000	Zipper foot	1		
713	000255012-000	Seam ripper	1		
714	051387000-661	Thread bobbin Holder	1		
715	000254021-000	Spool pin felt	1		
716	001012001-000	Foot controller cover	1		
717	000250889-000	Carton case	1		
718	000894000-000	Cellular plastics	1		
719	000368893-000	Instruction book	1		
720	001074005-000	Rating plate	1		

# JUKI

## JUKI CORPORATION

HEAD OFFICE  
8-2-1, KOKURYO-CHO,  
CHOFU-SHI, TOKYO, JAPAN.

BUSINESS OFFICE  
1-23-3, KABUKI-CHO,  
SHINJUKU-KU, TOKYO 160, JAPAN.

CABLE : JUKI TOKYO  
TELEX : J22967, 232-2301  
PHONE : 03(3205)8556

